

A.P. To be restored of the Dotted line is Claim'd by Samuel Martin
by Virtue of his Patent Dated 31st of Decem^r 1794

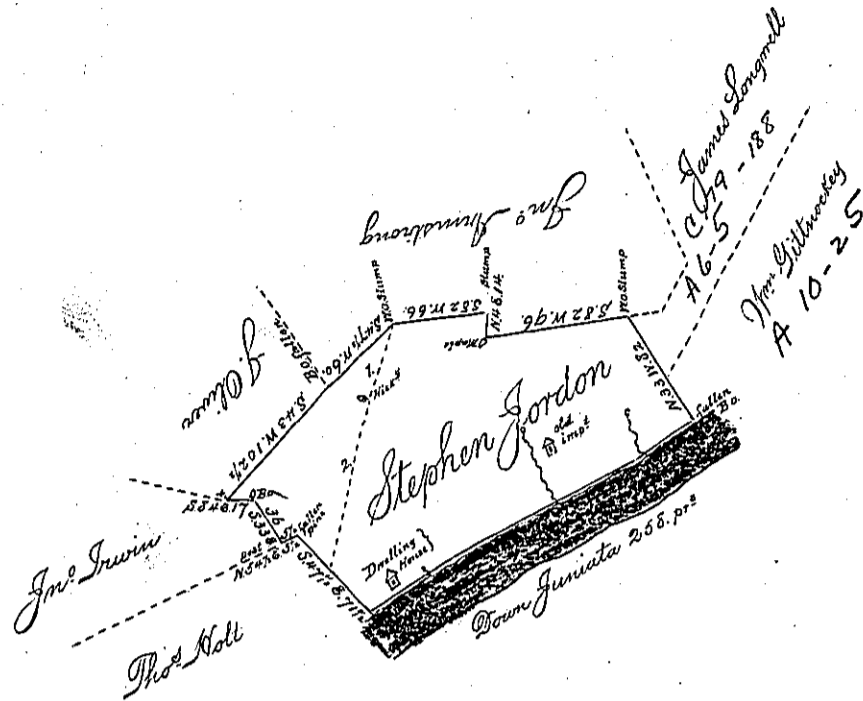

From Juniata
Course & Distance
N 57 E 63
N 62 E 144
N 55 E 46
Total 258 p'.

Draught of a tract of Land situate on the north side of Juniata River Dewey Township (formerly Cumberland) now Mifflin County containing Two Hundred & seven acres & 88 perches and the allowance of Six p^{ts} cent for Roads &c. Survey'd the 10th day of October 1801 - In pursuance of an application Granted to Stephen Jordan the 2^d August 1766 - N^o 672 - W^m Harris D.S.

Notes - The dotted lines on the above draught represent lines said to have been formerly run for Stephen Jordan agreeable to a Need Poll from David Woge Esq^r High Sheriff for Cumberland County to William Lyon Esquire sold as the property of Stephen Jordan bearing date the 28th day of January 1769 and Recorded February 14th 1769 - Given under the hand & the Seal of said Office at Carlisle January 23rd 1802.

sign^d George Kline Recorder.

Note - the Course & Distance of the Dotted lines are 1st from W^o stump thence S 21 W 43 perches to mark^d Hick^y Saplin thence 2^d S 13 1/2 W 129 perches ~~run~~ until I intersect the Line Thos. Holt - the last of these lines is not mark^d nor is there any Corner trees to be found on the line of Thos. Holt - about 2 1/2 Degrees Given for Variation -

William Harris D.S.

To Samuel Cochran Esq^r
Surv^r Gen^l Pennsylvania

IN TESTIMONY that the above is a copy of the original remaining on file in the Department of Internal Affairs of Pennsylvania, made conformably to an Act of Assembly approved the 16th day of February, 1833, I have hereunto set my Hand and caused the Seal of said Department to be affixed at Harrisburg, this

Second day of August 1898.

James W. Latta
Secretary of Internal Affairs.